

aiwa



NSX-T9

COMPACT DISC STEREO
CASSETTE RECEIVER

• TYPE: HA

SIMPLE MANUAL

• Replace this Service Manual with "Revision Publishing" when it is issued.

S/M Code No. 09-993-407-1T2

MANUAL
SERVICE

ELECTRICAL MAIN PARTS LIST - 1/8

NOTE: The characters in the suffix column indicate the part usage.

HASM	REF.NO	PARTS NO.	XX. KANRI NO.	DESCRIPTION	D. SUFFIX
C	603	87-010-112-040		CAP,E 100-16	ABCD.....
C	602	87-010-186-080		CAP,CHIP 4700P	ABCD.....
C	601	87-010-196-080		CHIP CAPACITOR,0.1-25	ABCD.....
C	607	87-010-197-080		CAP, CHIP 0.01 DM	ABCD.....
C	606	87-010-320-080		CHIP CAP 68P	ABCD.....
C	604	87-010-405-040		CAP,E 10-50	ABCD.....
C	605	87-010-546-040		CAP,E 0.33-50	ABCD.....
J	602	87-A60-651-010		JACK,3.5MONO	ABCD.....
J	601	87-A60-651-010		JACK,3.5MONO	ABCD.....
Q	604	87-A30-075-080		C-TR,2SA1235F	ABCD.....
Q	602	87-A30-076-080		C-TR,2SC3052F	ABCD.....
Q	603	87-A30-076-080		C-TR,2SC3052F	ABCD.....
Q	601	87-A30-087-080		C-FET,2SK2158	ABCD.....
		87-067-680-010		BVI T3+3-10	...D.....
C	101	87-010-387-080		CAP,E 470-25 SME	ABCD.....
C	107	87-A11-148-080		CAP,TC U 0.1-50 Z F	ABCD.....
C	108	87-A11-148-080		CAP,TC U 0.1-50 Z F	ABCD.....
C	109	87-A11-148-080		CAP,TC U 0.1-50 Z F	ABCD.....
C	116	87-010-403-080		CAP, ELECT 3.3-50V	ABCD.....
C	111	87-010-917-090		CAP,E 3300-50 M SMG	ABCD.....
C	112	87-010-917-090		CAP,E 3300-50 M SMG	ABCD.....
C	113	87-A10-231-090		CAP,E 3300-80	ABCD.....
C	114	87-A10-231-090		CAP,E 3300-80	ABCD.....
C	110	87-A11-148-080		CAP,TC U 0.1-50 Z F	ABCD.....
CN	1	87-A60-851-010		CONN,9P V VH	ABCD.....
D	101	87-017-447-010		DIODE,GBU4DL	ABCD.....
D	102	87-017-654-060		DIODE,GBU6J	ABCD.....
D	108	87-020-465-080		DIODE,1SS133 (110MA)	ABCD.....
D	109	87-020-465-080		DIODE,1SS133 (110MA)	ABCD.....
D	103	87-020-465-080		DIODE,1SS133 (110MA)	ABCD.....
D	105	87-020-465-080		DIODE,1SS133 (110MA)	ABCD.....
D	107	87-020-465-080		DIODE,1SS133 (110MA)	ABCD.....
D	106	87-020-465-080		DIODE,1SS133 (110MA)	ABCD.....
D	104	87-020-465-080		DIODE,1SS133 (110MA)	ABCD.....
FC	100	87-033-213-080		CLAMP, FUSE	...D.....
FC	101	87-033-213-080		CLAMP, FUSE	...D.....
FC	100	87-A90-505-080		FUSE CLAMP,TP00351-51	ABC.....
FC	101	87-A90-505-080		FUSE CLAMP,TP00351-51	ABC.....
PR	103	87-026-682-080		PROTECTOR,10A 60V491	AB.D.....
PR	101	87-026-682-080		PROTECTOR,10A 60V491	AB.D.....
PR	104	87-026-682-080		PROTECTOR,10A 60V491	AB.D.....
PR	102	87-026-682-080		PROTECTOR,10A 60V491	AB.D.....
PR	102	87-026-691-080		FUSE,10A 125V 251	...C.....
PR	101	87-026-691-080		FUSE,10A 125V 251	...C.....
PR	104	87-026-691-080		FUSE,10A 125V 251	...C.....
PR	103	87-026-691-080		FUSE,10A 125V 251	...C.....
PR	107	87-035-495-080		FUSE,3/4A 125V D/U/C	...C.....
PR	106	87-A90-195-080		PROTECTOR 7A 125V 49	AB.D.....
PR	105	87-A90-195-080		PROTECTOR 7A 125V 49	AB.D.....
PR	106	87-A90-210-080		FUSE,7A 125V 251	...C.....
PR	105	87-A90-210-080		FUSE,7A 125V 251	...C.....
PR	107	87-A90-757-080		PROTECTOR,0.75A 60V 491	AB.D.....
PR	108	87-A91-276-080		FUSE,125MA 125V F 251	...C.....
PT	2	8Z-NF8-661-010		PT,SUB ZNF-8(U)	...C.....
PT	2	8Z-NF8-662-010		PT,SUB ZNF-8(E)	...C.....
PT	2	8Z-NF8-663-010		PT,SUB ZNF-8(H)	AB.D.....
Q	101	87-026-245-080		TR,DTC114ES	ABCD.....
Q	102	87-A30-198-080		TR,KTC3199GR	ABCD.....
RY	102	87-A90-976-010		RELAY,AC12V SDT-S-112LMR	...C.....
RY	101	87-A91-281-010		RELAY,AC DC12V OSA-SS-212DM5	AB.D.....
SW	101	87-A90-165-010		SW,SL 1-2-3 SWS2301	AB.D.....
T	101	87-A60-317-010		TERMINAL, 1P MSC	ABCD.....
T	102	87-A60-317-010		TERMINAL, 1P MSC	ABCD.....
		87-NB6-212-010		GUIDE,LED L IND	ABCD.....
*		8Z-NF3-210-010		GUIDE,FL	ABCD.....
*		8Z-NF3-211-010		GUIDE,LED FUN	ABCD.....
*		8Z-NF3-212-010		GUIDE,LED OPE	ABCD.....
C	104	87-010-313-080		CAP, CHIP 18P	ABCD.....
C	105	87-010-322-080		C-CAP,S 100P-50 CH	ABCD.....
C	106	87-012-145-080		CAP, CHIP S 270P CH	ABCD.....
C	107	87-012-157-080		C-CAP,S 330P-50 CH	ABCD.....
C	108	87-015-681-040		E/CAP 10-16	ABCD.....
C	110	87-010-180-080		C-CER 1500P	ABCD.....
C	118	87-010-194-080		CAP, CHIP 0.047	ABCD.....
C	115	87-010-198-080		CAP, CHIP 0.022	ABCD.....
C	116	87-010-493-040		CAP,E 0.47-50 GAS	ABCD.....
C	117	87-010-498-040		CAP,E 10-16 GAS	ABCD.....
C	113	87-A10-189-040		CAP,E 220-10	ABCD.....
C	119	87-A10-586-040		CAP,E 47-35 7L SR	ABCD.....
C	128	87-010-178-080		CHIP CAP 1000P	ABCD.....
C	129	87-010-194-080		CAP, CHIP 0.047	ABCD.....
C	122	87-010-197-080		CAP, CHIP 0.01 DM	ABCD.....
C	121	87-015-699-040		CAP,E 10-50 7L	ABCD.....
C	120	87-015-699-040		CAP,E 10-50 7L	ABCD.....
C	130	87-010-264-040		CAP,E 100-10 5L	ABCD.....
C	151	87-010-194-080		CAP, CHIP 0.047	ABCD.....

ELECTRICAL MAIN PARTS LIST - 2/8

C	150	87-010-194-080	CAP, CHIP 0.047	ABCD.....
C	162	87-010-182-080	C-CAP,S 2200P-50 B	ABCD.....
C	161	87-010-197-080	CAP, CHIP 0.01 DM	ABCD.....
C	196	87-010-194-080	CAP, CHIP 0.047	ABCD.....
C	197	87-010-194-080	CAP, CHIP 0.047	ABCD.....
C	357	87-010-196-080	CHIP CAPACITOR,0.1-25	ABCD.....
C	351	87-012-158-080	C-CAP,S 390P-50 CH	ABCD.....
C	401	87-010-196-080	CHIP CAPACITOR,0.1-25	ABCD.....
C	407	87-010-322-080	C-CAP,S 100P-50 CH	ABCD.....
C	410	87-010-196-080	CHIP CAPACITOR,0.1-25	ABCD.....
C	417	87-010-322-080	C-CAP,S 100P-50 CH	ABCD.....
C	502	87-010-182-080	C-CAP,S 2200P-50 B	ABCD.....
C	501	87-010-197-080	CAP, CHIP 0.01 DM	ABCD.....
C	531	87-010-196-080	CHIP CAPACITOR,0.1-25	ABCD.....
C	532	87-010-196-080	CHIP CAPACITOR,0.1-25	ABCD.....
C	701	87-010-981-040	CAP,E 22-35 5L SRE	ABCD.....
C	901	87-012-157-080	C-CAP,S 330P-50 CH	ABCD.....
C	912	87-010-176-080	C-CAP,S 680P-50 SL	ABCD.....
C	913	87-010-176-080	C-CAP,S 680P-50 SL	ABCD.....
C	971	87-010-318-080	C-CAP,S 47P-50 CH
C	970	87-010-318-080	C-CAP,S 47P-50 CH
CN	102	87-099-032-010	CONN,15P 6216 H	ABCD.....
CN	101	87-099-720-010	CONN,30P TYK-B(P)	ABCD.....
CN	301	87-099-202-010	CONN,9P 6216 H	ABCD.....
CN	302	87-A60-078-010	CONN,09P H 9604S-09F	ABCD.....
CN	501	87-099-201-010	CONN,8P 6216 H	ABCD.....
CN	502	87-A60-059-010	CONN,08P V 9604S-08C	ABCD.....
CN	701	87-099-750-010	CONN,15P V 9604SC	ABCD.....
D	107	87-A40-270-080	C-DIODE,MC2838	ABCD.....
D	109	87-A40-440-080	ZENER,MTZJ7.5A	ABCD.....
D	310	87-017-932-080	ZENER,MTJ6.2B	ABCD.....
D	338	87-020-465-080	DIODE,1SS133 (110MA)	ABCD.....
D	333	87-020-465-080	DIODE,1SS133 (110MA)	ABCD.....
D	337	87-020-465-080	DIODE,1SS133 (110MA)	ABCD.....
D	336	87-020-465-080	DIODE,1SS133 (110MA)	ABCD.....
D	335	87-020-465-080	DIODE,1SS133 (110MA)	ABCD.....
D	334	87-020-465-080	DIODE,1SS133 (110MA)	ABCD.....
D	701	87-A40-269-080	C-DIODE,MC2836	ABCD.....
FL	101	8Z-NF3-611-010	FL,BJ680GK-ZNF3	ABCD.....
IC	102	87-A20-914-010	IC,SPS-442-1-F	ABCD.....
IC	101	8Z-NF3-605-010	C-IC,LC876580W-****	ABCD.....
IC	380	87-A21-023-040	C-IC,BA3835F	ABCD.....
IC	402	87-A21-021-040	C-IC,BU2099FV	ABCD.....
IC	401	87-A21-021-040	C-IC,BU2099FV	ABCD.....
JR	125	83-XM1-617-080	C-COIL,BK2125HM601	ABC.....
JW	101	82-226-689-080	COIL,2.2MH J	ABC.....
JW	248	87-A90-896-080	F-BEAD, 035600STY7
L	101	87-A50-333-010	COIL,OSC 9.43MHZ	ABCD.....
L	601	87-005-847-080	COIL,2.2UH(CECS)	...D.....
LED	101	87-A40-589-040	LED,SLR-56VCT31 RED	ABCD.....
LED	315	87-A40-317-080	LED,SLR-342VCT31 RED	ABCD.....
LED	314	87-A40-317-080	LED,SLR-342VCT31 RED	ABCD.....
LED	313	87-A40-317-080	LED,SLR-342VCT31 RED	ABCD.....
LED	312	87-A40-317-080	LED,SLR-342VCT31 RED	ABCD.....
LED	311	87-A40-317-080	LED,SLR-342VCT31 RED	ABCD.....
LED	351	87-A40-563-010	LED,SEL6515C-LF62 PGRN	ABCD.....
LED	352	87-A40-563-010	LED,SEL6515C-LF62 PGRN	ABCD.....
LED	353	87-A40-563-010	LED,SEL6515C-LF62 PGRN	ABCD.....
LED	424	87-070-278-010	LED,SLZ-738A-24-S	ABCD.....
LED	426	87-070-278-010	LED,SLZ-738A-24-S	ABCD.....
LED	423	87-070-278-010	LED,SLZ-738A-24-S	ABCD.....
LED	421	87-070-278-010	LED,SLZ-738A-24-S	ABCD.....
LED	425	87-070-290-010	LED,SLZ 936-30-S	ABCD.....
LED	422	87-070-290-010	LED,SLZ 936-30-S	ABCD.....
LED	456	87-A40-619-040	LED,SLR-56PT-T31-W GRN	ABCD.....
LED	455	87-A40-619-040	LED,SLR-56PT-T31-W GRN	ABCD.....
LED	452	87-A40-619-040	LED,SLR-56PT-T31-W GRN	ABCD.....
LED	454	87-A40-619-040	LED,SLR-56PT-T31-W GRN	ABCD.....
LED	453	87-A40-619-040	LED,SLR-56PT-T31-W GRN	ABCD.....
LED	451	87-A40-619-040	LED,SLR-56PT-T31-W GRN	ABCD.....
LED	463	87-A40-317-080	LED,SLR-342VCT31 RED	ABCD.....
LED	464	87-A40-317-080	LED,SLR-342VCT31 RED	ABCD.....
LED	461	87-A40-317-080	LED,SLR-342VCT31 RED	ABCD.....
LED	462	87-A40-317-080	LED,SLR-342VCT31 RED	ABCD.....
LED	465	87-A40-317-080	LED,SLR-342VCT31 RED	ABCD.....
LED	521	87-A40-640-010	LED,SELU1E10CXM BLUE-EF	ABCD.....
LED	522	87-A40-640-010	LED,SELU1E10CXM BLUE-EF	ABCD.....
Q	104	87-026-610-080	TR,KTC3198GR	ABCD.....
Q	108	87-A30-073-080	C-TR,RT1N 141C	ABCD.....
Q	102	87-A30-087-080	C-FET,2SK2158	ABCD.....
Q	101	87-A30-087-080	C-FET,2SK2158	ABCD.....
Q	109	87-A30-087-080	C-FET,2SK2158	ABCD.....
Q	301	87-A30-276-040	C-TR,DTA143EKA	ABCD.....
Q	311	87-A30-075-080	C-TR,2SA1235F	ABCD.....
Q	401	87-A30-075-080	C-TR,2SA1235F	ABCD.....
Q	703	87-A30-067-080	C-TR,2SA 1298Y	...D.....
Q	702	87-A30-067-080	C-TR,2SA 1298Y	...D.....
Q	702	87-A30-159-080	C-TR,KTA1298Y	ABC.....
Q	703	87-A30-159-080	C-TR,KTA1298Y	ABC.....
Q	701	87-A30-240-080	TR,CSA1585BC	ABC.....
S	262	87-A90-095-080	SW,TACT EVO11G04M	ABCD.....
SW	101	87-A90-535-010	SW,RTRY EC16B24304	ABCD.....

ELECTRICAL MAIN PARTS LIST - 3/8

SW	501	87-A91-111-010	SW,RTRY EC12E12404-20MM	ABCD.....
C	806	87-010-071-040	CAP,E 1-50 M 5L SRE	ABCD.....
C	802	87-010-176-080	C-CAP,S 680P-50 SL	ABCD.....
C	803	87-010-187-080	CAP CHIP S5600P	ABCD.....
C	807	87-010-196-080	CHIP CAPACITOR,0.1-25	ABCD.....
C	804	87-010-213-080	C-CAP,S 0.015-50 B	ABCD.....
C	801	87-012-145-080	CAP, CHIP S 270P CH	...D.....
C	809	87-012-155-080	C-CAP 180P-50CH	ABCD.....
C	801	87-012-156-080	C-CAP,S 220P-50 CH	ABC.....
C	812	87-010-060-040	CAP,E 100-16	ABCD.....
C	810	87-010-561-040	CAP,E 100-16 GAS	ABCD.....
C	811	87-015-682-040	CAP,E 22-16 7L	ABCD.....
C	821	87-010-197-080	CAP, CHIP 0.01 DM	ABCD.....
C	823	87-010-197-080	CAP, CHIP 0.01 DM	ABCD.....
C	822	87-015-819-080	CAPACITOR,0.01	ABCD.....
C	833	87-010-322-080	C-CAP,S 100P-50 CH	ABCD.....
D	801	87-017-931-080	ZENER,MTZJ5.6B	ABCD.....
IC	801	87-A21-051-040	C-IC,BU9990-03FS	ABCD.....
L	801	87-A50-093-010	COIL,CLOCK 5.76MHZ	ABCD.....
C	307	87-010-196-080	CHIP CAPACITOR,0.1-25	ABCD.....
C	306	87-012-145-080	CAP, CHIP S 270P CH	ABCD.....
C	305	87-012-145-080	CAP, CHIP S 270P CH	ABCD.....
C	303	87-012-157-080	C-CAP,S 330P-50 CH	ABCD.....
C	304	87-012-157-080	C-CAP,S 330P-50 CH	ABCD.....
C	313	87-010-180-080	C-CER 1500P	ABC.....
C	314	87-010-180-080	C-CER 1500P	ABC.....
C	313	87-010-181-080	CAP,CHIP S 1800P	...D.....
C	314	87-010-181-080	CAP,CHIP S 1800P	...D.....
C	312	87-010-198-080	CAP, CHIP 0.022	ABCD.....
C	311	87-010-198-080	CAP, CHIP 0.022	ABCD.....
C	319	87-012-141-080	CHIP-CAPACITOR,0.22-16F	ABCD.....
C	317	87-012-142-080	CAP, S 0.33-16	ABCD.....
C	318	87-012-142-080	CAP, S 0.33-16	ABCD.....
C	324	87-010-260-080	CAP, ELECT 47-25V	ABCD.....
C	325	87-010-370-080	CAP,E 330-6.3 SME	ABCD.....
C	327	87-010-404-080	CAP, ELECT 4.7-50V	ABCD.....
C	328	87-010-404-080	CAP, ELECT 4.7-50V	ABCD.....
C	320	87-012-141-080	CHIP-CAPACITOR,0.22-16F	ABCD.....
C	322	87-012-142-080	CAP, S 0.33-16	ABCD.....
C	321	87-012-142-080	CAP, S 0.33-16	ABCD.....
C	339	87-010-196-080	CHIP CAPACITOR,0.1-25	ABCD.....
C	332	87-010-196-080	CHIP CAPACITOR,0.1-25	ABCD.....
C	337	87-010-196-080	CHIP CAPACITOR,0.1-25	ABCD.....
C	336	87-010-401-080	CAP, ELECT 1-50V	ABCD.....
C	335	87-010-401-080	CAP, ELECT 1-50V	ABCD.....
C	340	87-010-196-080	CHIP CAPACITOR,0.1-25	ABCD.....
C	358	87-010-183-080	C-CAP,S 2700P-50 B	ABCD.....
C	359	87-010-183-080	C-CAP,S 2700P-50 B	ABCD.....
C	357	87-010-197-080	CAP, CHIP 0.01 DM	ABCD.....
C	356	87-010-260-080	CAP, ELECT 47-25V	ABCD.....
C	351	87-012-140-080	CAP 470P	ABCD.....
C	352	87-012-140-080	CAP 470P	ABCD.....
C	355	87-012-349-080	C-CAP,S 1000P-50 CH	ABCD.....
C	360	87-010-183-080	C-CAP,S 2700P-50 B	ABCD.....
C	363	87-A10-772-080	CAP,M 5600P-50 J	ABCD.....
C	372	87-010-175-080	CAP 560P	ABCD.....
C	371	87-010-175-080	CAP 560P	ABCD.....
C	373	87-010-179-080	CAP,CHIP S B1200P	ABCD.....
C	374	87-010-179-080	CAP,CHIP S B1200P	ABCD.....
C	370	87-010-196-080	CHIP CAPACITOR,0.1-25	ABCD.....
C	378	87-010-196-080	CHIP CAPACITOR,0.1-25	ABCD.....
C	376	87-010-545-080	CAP, ELECT 0.22-50V	ABCD.....
C	375	87-010-545-080	CAP, ELECT 0.22-50V	ABCD.....
C	385	87-010-184-080	CHIP CAPACITOR 3300P(K)	ABCD.....
C	386	87-010-196-080	CHIP CAPACITOR,0.1-25	ABCD.....
C	383	87-010-197-080	CAP, CHIP 0.01 DM	ABCD.....
C	381	87-010-197-080	CAP, CHIP 0.01 DM	ABCD.....
C	382	87-010-318-080	C-CAP,S 47P-50 CH	ABCD.....
C	384	87-010-402-080	CAP, ELECT 2.2-50V	ABCD.....
C	384	87-010-403-080	CAP, ELECT 3.3-50V
C	388	87-012-156-080	C-CAP,S 220P-50 CH	ABCD.....
CN	301	87-099-827-010	CONN,3P S2M-3W	ABC.....
CN	301	87-A60-620-010	CONN,3P V 2MM JMT	...D.....
CN	351	87-099-832-010	CONN,8P S2M-8W	ABC.....
CN	351	87-A60-625-010	CONN,8P V 2MM JMT	...D.....
D	352	87-A40-269-080	C-DIODE,MC2836	ABCD.....
FB	301	87-008-372-080	FILTER, EMI BL OIRNI
IC	302	87-A20-355-010	IC,CXA1553P	ABCD.....
IC	303	87-A20-783-040	C-IC,BA7762AFS	ABCD.....
L	301	87-A50-049-010	COIL,TRAP 85K(COI)	ABCD.....
L	302	87-A50-049-010	COIL,TRAP 85K(COI)	ABCD.....
L	351	87-007-342-010	COIL,OSC 85K BIAS	ABCD.....
Q	357	87-026-610-080	TR,KTC3198GR	ABCD.....
Q	359	87-026-610-080	TR,KTC3198GR	ABCD.....
Q	358	87-026-610-080	TR,KTC3198GR	ABCD.....
Q	356	87-A30-076-080	C-TR,2SC3052F	ABCD.....
Q	354	87-A30-087-080	C-FET,2SK2158	ABCD.....
Q	353	87-A30-087-080	C-FET,2SK2158	ABCD.....
Q	351	87-A30-087-080	C-FET,2SK2158	ABCD.....
Q	355	87-A30-105-080	C-TR,RT1P 441C	ABCD.....
SFR	303	87-024-355-080	SFR,33K DIA6 H	ABCD.....
SFR	302	87-024-355-080	SFR,33K DIA6 H	ABCD.....

ELECTRICAL MAIN PARTS LIST - 4/8

SFR	301	87-024-355-080	SFR,33K DIA6 H	ABCD.....
SFR	304	87-024-355-080	SFR,33K DIA6 H	ABCD.....
SFR	306	87-024-356-080	SFR,47K DIA6 H	ABCD.....
SFR	305	87-024-356-080	SFR,47K DIA6 H	ABCD.....
C	407	87-010-188-080	CAP,CHIP 6800P	ABCD.....
C	408	87-010-188-080	CAP,CHIP 6800P	ABCD.....
C	401	87-010-196-080	CHIP CAPACITOR,0.1-25	ABCD.....
C	402	87-010-260-080	CAP, ELECT 47-25V	ABCD.....
C	404	87-010-404-080	CAP, ELECT 4.7-50V	ABCD.....
C	406	87-010-404-080	CAP, ELECT 4.7-50V	ABCD.....
C	405	87-010-404-080	CAP, ELECT 4.7-50V	ABCD.....
C	403	87-010-404-080	CAP, ELECT 4.7-50V	ABCD.....
C	409	87-012-140-080	CAP 470P	ABCD.....
C	415	87-010-197-080	CAP, CHIP 0.01 DM	ABCD.....
C	416	87-010-197-080	CAP, CHIP 0.01 DM	ABCD.....
C	419	87-010-260-080	CAP, ELECT 47-25V	ABCD.....
C	411	87-010-404-080	CAP, ELECT 4.7-50V	ABCD.....
C	412	87-010-404-080	CAP, ELECT 4.7-50V	ABCD.....
C	413	87-010-404-080	CAP, ELECT 4.7-50V	ABCD.....
C	414	87-010-404-080	CAP, ELECT 4.7-50V	ABCD.....
C	418	87-010-956-080	CHIP-CAP,S 0.068-25B	ABCD.....
C	410	87-012-140-080	CAP 470P	ABCD.....
D	402	87-020-465-080	DIODE,1SS133 (110MA)	ABCD.....
D	401	87-A40-269-080	C-DIODE,MC2836	ABCD.....
IC	401	87-A21-022-040	C-IC,BA3880FS	ABCD.....
C	507	87-010-183-080	C-CAP,S 2700P-50 B	A.....
C	509	87-010-196-080	CHIP CAPACITOR,0.1-25	A.....
C	505	87-012-145-080	CAP, CHIP S 270P CH	A.....
C	506	87-012-145-080	CAP, CHIP S 270P CH	A.....
C	503	87-012-154-080	C-CAP,S 150P-50 CH	A.....
C	504	87-012-154-080	C-CAP,S 150P-50 CH	A.....
C	501	87-A10-060-080	C-CAP,S 0.18-16 K B	A.....
C	502	87-A10-060-080	C-CAP,S 0.18-16 K B	A.....
C	510	87-010-177-080	C-CAP,S 820P-50 SL	A.....
C	511	87-010-177-080	C-CAP,S 820P-50 SL	A.....
C	517	87-010-183-080	C-CAP,S 2700P-50 B	A.....
C	514	87-010-196-080	CHIP CAPACITOR,0.1-25	A.....
C	512	87-010-196-080	CHIP CAPACITOR,0.1-25	A.....
C	515	87-010-263-080	CAP, ELECT 100-10V	A.....
C	513	87-010-380-080	CAP, ELECT 47-16V	A.....
C	527	87-010-196-080	CHIP CAPACITOR,0.1-25	A.....
C	523	87-016-460-080	C-CAP,S 0.22-16 B	A.....
C	522	87-016-460-080	C-CAP,S 0.22-16 B	A.....
C	521	87-016-460-080	C-CAP,S 0.22-16 B	A.....
CN	502	87-099-566-010	CONN,7P TUC-P7P-B1	A.....
CN	501	87-A60-689-010	CONN,7P H GRY TUC-P07X-C1	A.....
D	501	87-070-136-080	ZENER,MTZJ5.1B	A.....
IC	501	87-A20-561-040	C-IC,M65847AFP	A.....
C	458	87-010-196-080	CHIP CAPACITOR,0.1-25	ABCD.....
C	457	87-010-196-080	CHIP CAPACITOR,0.1-25	ABCD.....
C	453	87-010-400-080	CAP, ELECT 0.47-50V	ABCD.....
C	454	87-010-400-080	CAP, ELECT 0.47-50V	ABCD.....
C	452	87-010-404-080	CAP, ELECT 4.7-50V	ABCD.....
C	451	87-010-404-080	CAP, ELECT 4.7-50V	ABCD.....
C	461	87-010-067-080	CAP,E 0.1-50 5L	ABCD.....
C	463	87-010-546-080	CAP, ELECT 0.33-50V	ABCD.....
C	464	87-010-546-080	CAP, ELECT 0.33-50V	ABCD.....
C	465	87-A11-006-080	CAP,M 0.033-50 J DE	ABCD.....
C	466	87-A11-006-080	CAP,M 0.033-50 J DE	ABCD.....
IC	451	87-A21-031-040	C-IC,BU4551BF	ABCD.....
		87-067-680-010	BVI T3+3-10	...D.....
C	3	87-012-368-080	C-CAP,S 0.1-50 F	ABCD.....
C	5	87-012-368-080	C-CAP,S 0.1-50 F	ABCD.....
C	6	87-012-368-080	C-CAP,S 0.1-50 F	ABCD.....
C	4	87-012-368-080	C-CAP,S 0.1-50 F	ABCD.....
C	1	87-012-369-080	C-CAP,S 0.047-50F	ABCD.....
C	2	87-012-369-080	C-CAP,S 0.047-50F	ABCD.....
C	9	87-016-658-090	CAP,E 4700-35 SMG	ABCD.....
C	10	87-016-658-090	CAP,E 4700-35 SMG	ABCD.....
C	27	87-010-197-080	CAP, CHIP 0.01 DM
C	24	87-010-247-080	CAP, ELECT 100-50V	ABCD.....
C	23	87-010-247-080	CAP, ELECT 100-50V	ABCD.....
C	28	87-010-263-080	CAP, ELECT 100-10V	ABCD.....
C	22	87-010-385-080	CAP, ELECT 220-25V	ABCD.....
C	21	87-010-385-080	CAP, ELECT 220-25V	ABCD.....
C	25	87-010-430-080	CAP, ELECT 100-63	ABCD.....
C	27	87-012-140-080	CAP 470P	ABCD.....
C	30	87-010-112-080	CAP, ELECT 100-16V	ABC.....
C	31	87-010-235-010	ELECTROLYTIC, 470-16	...D.....
C	31	87-010-235-080	CAP,E 470-16 SME	ABC.....
C	30	87-010-381-080	CAP, ELECT 330-16V	...D.....
C	61	87-010-234-080	CAP 47-16	ABCD.....
C	62	87-010-415-080	CAP ELE SRE 10-50V	ABCD.....
C	93	87-010-380-080	CAP, ELECT 47-16V	ABCD.....
C	91	87-010-401-080	CAP, ELECT 1-50V	ABCD.....
CN	1	87-A60-739-010	CONN,13P JL-BT	ABCD.....
CN	92	87-A60-109-010	CONN,2P V S2M-2W	ABCD.....
CNA	1	8Z-NF3-645-010	CONN ASSY,9P VH	ABCD.....
D	8	87-020-465-080	DIODE,1SS133 (110MA)	ABCD.....
D	9	87-020-465-080	DIODE,1SS133 (110MA)	ABCD.....
D	1	87-A40-224-010	DIODE,GBU8D	ABCD.....
D	7	87-A40-503-080	ZENER,MTZJ39B	ABCD.....

ELECTRICAL MAIN PARTS LIST - 5/8

D	4	87-A40-553-080	DIODE,1N4003 LES	ABCD.....
D	3	87-A40-553-080	DIODE,1N4003 LES	ABCD.....
D	5	87-A40-553-080	DIODE,1N4003 LES	ABCD.....
D	6	87-A40-553-080	DIODE,1N4003 LES	ABCD.....
D	10	87-A40-345-080	ZENER,MTZJ10C	ABCD.....
D	64	87-070-274-080	DIODE,1N4003 SEM	ABCD.....
D	63	87-A40-004-080	ZENER,MTZJ16A	ABCD.....
D	62	87-A40-269-080	C-DIODE,MC2836	ABCD.....
D	61	87-A40-270-080	C-DIODE,MC2838	ABCD.....
D	91	87-020-465-080	DIODE,1SS133 (110MA)	ABCD.....
D	92	87-020-465-080	DIODE,1SS133 (110MA)	ABCD.....
JW	82	87-A90-896-080	F-BEAD, 035600STY7	...D.....
Q	2	87-026-609-080	TR,KTA1266GR	ABC.....
Q	1	87-026-609-080	TR,KTA1266GR	ABC.....
Q	5	87-026-610-080	TR,KTC3198GR	ABCD.....
Q	7	87-A30-075-080	C-TR,2SA1235F	ABCD.....
Q	6	87-A30-076-080	C-TR,2SC3052F	ABCD.....
Q	9	87-A30-196-080	TR,2SC4115SRS	ABCD.....
Q	1	87-A30-217-010	TR,2SB1436(R)
Q	1	87-A30-218-080	TR,2SB1237(Q)	...D.....
Q	2	87-A30-218-080	TR,2SB1237(Q)	...D.....
Q	67	87-A30-076-080	C-TR,2SC3052F	ABCD.....
Q	65	87-A30-076-080	C-TR,2SC3052F	ABCD.....
Q	63	87-A30-076-080	C-TR,2SC3052F	ABCD.....
Q	91	87-A30-076-080	C-TR,2SC3052F	ABCD.....
Q	92	87-A30-240-080	TR,CSA1585BC	A..D.....
R	20	87-A00-261-080	RES,M/F 0.56-1W J	..C.....
WH	1	87-A90-510-010	HLDR,WIRE 2.5-9P	ABCD.....
C	102	87-010-182-080	C-CAP,S 2200P-50 B	ABCD.....
C	101	87-010-182-080	C-CAP,S 2200P-50 B	ABCD.....
C	124	87-010-176-080	C-CAP,S 680P-50 SL
C	123	87-010-176-080	C-CAP,S 680P-50 SL
C	129	87-010-191-080	C-CAP,S 0.015-50 F
C	127	87-012-368-080	C-CAP,S 0.1-50 F	ABCD.....
C	125	87-012-368-080	C-CAP,S 0.1-50 F	ABCD.....
C	128	87-012-368-080	C-CAP,S 0.1-50 F	ABCD.....
C	126	87-012-368-080	C-CAP,S 0.1-50 F	ABCD.....
C	130	87-010-191-080	C-CAP,S 0.015-50 F
C	132	87-010-197-080	CAP,CHIP 0.01 DM
C	131	87-010-197-080	CAP,CHIP 0.01 DM
C	134	87-010-498-080	CAP,E 10-16 GAS	ABCD.....
J	203	87-A60-238-010	TERMINAL,SP 4P (MSC)	ABCD.....
J	201	87-A60-483-010	JACK,DIA6.3 BLK ST W/S KM	ABCD.....
JW	112	87-A90-896-080	F-BEAD, 035600STY7	ABCD.....
L	101	87-003-383-010	COIL,1UH-S	ABCD.....
L	102	87-003-383-010	COIL,1UH-S	ABCD.....
Q	101	87-A30-257-080	C-TR,2SD1306E	ABCD.....
Q	102	87-A30-257-080	C-TR,2SD1306E	ABCD.....
Q	127	87-A30-075-080	C-TR,2SA1235F	ABCD.....
C	203	87-010-178-080	CHIP CAP 1000P	ABCD.....
C	204	87-010-178-080	CHIP CAP 1000P	ABCD.....
C	229	87-010-993-080	C-CAP,S 0.056-25 B	ABCD.....
C	233	87-010-190-080	S CHIP F 0.01
C	234	87-010-190-080	S CHIP F 0.01
C	239	87-010-196-080	CHIP CAPACITOR,0.1-25	ABCD.....
C	231	87-010-196-080	CHIP CAPACITOR,0.1-25	ABCD.....
C	232	87-010-196-080	CHIP CAPACITOR,0.1-25	ABCD.....
C	237	87-010-322-080	C-CAP,S 100P-50 CH
C	238	87-010-322-080	C-CAP,S 100P-50 CH
C	230	87-010-993-080	C-CAP,S 0.056-25 B	ABCD.....
C	235	87-016-285-080	CAP,E 47-100SME	ABCD.....
C	236	87-016-285-080	CAP,E 47-100SME	ABCD.....
CN	201	87-A60-739-010	CONN,13P JL-BT	ABCD.....
D	212	87-020-465-080	DIODE,1SS133 (110MA)	ABCD.....
J	206	87-A60-750-010	JACK,PIN 4P R/W BLUE	ABCD.....
L	202	87-003-383-010	COIL,1UH-S	ABCD.....
L	201	87-003-383-010	COIL,1UH-S	ABCD.....
Q	201	87-A30-257-080	C-TR,2SD1306E	ABCD.....
Q	202	87-A30-257-080	C-TR,2SD1306E	ABCD.....
Q	221	87-A30-073-080	C-TR,RT1N 141C	ABCD.....
RY	201	87-045-382-010	RELAY,OUAZ-SH-112L	ABCD.....
C	607	87-010-318-080	C-CAP,S 47P-50 CH	ABCD.....
C	608	87-010-318-080	C-CAP,S 47P-50 CH	ABCD.....
C	605	87-010-318-080	C-CAP,S 47P-50 CH	ABCD.....
C	606	87-010-318-080	C-CAP,S 47P-50 CH	ABCD.....
C	619	87-010-185-080	C-CAP,S 3900P-50 B	ABCD.....
C	613	87-016-081-080	C-CAP,S 0.1-16 RK	ABCD.....
C	614	87-016-081-080	C-CAP,S 0.1-16 RK	ABCD.....
C	618	87-A11-009-080	CAP,M 0.068-50 J DE	ABCD.....
C	617	87-A11-009-080	CAP,M 0.068-50 J DE	ABCD.....
C	615	87-A11-011-080	CAP,M 0.12-50 J DE	ABCD.....
C	616	87-A11-011-080	CAP,M 0.12-50 J DE	ABCD.....
C	620	87-010-185-080	C-CAP,S 3900P-50 B	ABCD.....
C	622	87-010-401-080	CAP, ELECT 1-50V	ABCD.....
C	625	87-010-401-080	CAP, ELECT 1-50V	ABCD.....
C	621	87-010-401-080	CAP, ELECT 1-50V	ABCD.....
C	626	87-010-401-080	CAP, ELECT 1-50V	ABCD.....
C	629	87-010-405-080	CAP, ELECT 10-50V	ABCD.....
C	624	87-A10-773-080	CAP,M 0.10-50 J	ABCD.....
C	623	87-A10-773-080	CAP,M 0.10-50 J	ABCD.....
C	637	87-010-183-080	C-CAP,S 2700P-50 B	ABCD.....
C	630	87-010-213-080	C-CAP,S 0.015-50 B	ABCD.....

ELECTRICAL MAIN PARTS LIST - 6/8

C	633	87-010-263-080	CAP, ELECT 100-10V	ABCD.....
C	632	87-010-263-080	CAP, ELECT 100-10V	ABCD.....
C	631	87-010-992-080	C-CAP,S 0.047-25 B	ABCD.....
C	636	87-010-992-080	C-CAP,S 0.047-25 B	ABCD.....
C	640	87-010-314-080	C-CAP,S 22P-50V	ABCD.....
C	662	87-010-322-080	C-CAP,S 100P-50 CH	ABCD.....
C	669	87-010-322-080	C-CAP,S 100P-50 CH	ABCD.....
C	663	87-010-322-080	C-CAP,S 100P-50 CH	ABCD.....
C	664	87-010-322-080	C-CAP,S 100P-50 CH	ABCD.....
C	661	87-010-322-080	C-CAP,S 100P-50 CH	ABCD.....
C	679	87-010-178-080	CHIP CAP 1000P
C	679	87-010-196-080	CHIP CAPACITOR,0.1-25	ABCD.....
C	671	87-010-322-080	C-CAP,S 100P-50 CH	ABCD.....
C	672	87-010-322-080	C-CAP,S 100P-50 CH	ABCD.....
C	670	87-010-322-080	C-CAP,S 100P-50 CH	ABCD.....
CN	604	87-099-570-010	CONN,13P TUC-P13P-B1	ABCD.....
CN	601	87-099-719-010	CONN,30P TYK-B(X)	ABCD.....
CN	602	87-A60-061-010	CONN,06P V 9604S-06C	ABCD.....
CN	605	87-A60-189-010	CONN,16P V TUC-P16P-B1
D	601	87-A40-002-080	ZENER,MTZJ5.1C	ABCD.....
D	603	87-A40-234-080	ZENER,MTZJ5.6A	ABCD.....
D	602	87-A40-438-080	ZENER,MTZJ4.7A	ABCD.....
IC	601	87-A21-202-040	C-IC,M62445AFP	ABCD.....
J	601	87-A60-426-010	JACK,PIN 6P YKC21-3835	ABCD.....
JR	630	83-XM1-617-080	C-COIL,BK2125HM601
Q	604	87-026-444-080	C-TR,DTA123EK	ABC.....
Q	601	87-026-609-080	TR,KTA1266GR	ABCD.....
Q	603	87-A30-087-080	C-FET,2SK2158
Q	604	87-A30-142-040	C-TR,DTA123EKAD.....
Q	602	87-A30-269-040	C-FET,2SJ461-T1
C	707	87-010-180-080	C-CER 1500P	ABCD.....
C	706	87-010-197-080	CAP, CHIP 0.01 DM	ABCD.....
C	708	87-010-213-080	C-CAP,S 0.015-50 B	ABCD.....
C	709	87-010-213-080	C-CAP,S 0.015-50 B	ABCD.....
C	701	87-010-263-080	CAP, ELECT 100-10V	ABCD.....
C	703	87-010-319-080	C-CAP,S 56P-50 CH	ABCD.....
C	704	87-010-319-080	C-CAP,S 56P-50 CH	ABCD.....
C	705	87-012-393-080	C-CAP,S 0.22-16 R K	ABCD.....
C	715	87-010-071-080	CAP, ELECT 1-50 M 5L SRE	ABCD.....
C	716	87-010-071-080	CAP, ELECT 1-50 M 5L SRE	ABCD.....
C	711	87-010-181-080	CAP,CHIP S 1800P	ABCD.....
C	717	87-010-183-080	C-CAP,S 2700P-50 B	ABCD.....
C	718	87-010-183-080	C-CAP,S 2700P-50 B	ABCD.....
C	710	87-010-197-080	CAP, CHIP 0.01 DM	ABCD.....
C	714	87-010-374-080	CAP, ELECT 47-10V	ABCD.....
C	713	87-010-544-080	CAP, ELECT 0.1-50V	ABCD.....
C	719	87-A11-014-080	CAP,M 0.22-50 J DE	ABCD.....
C	735	87-010-178-080	CHIP CAP 1000P	ABCD.....
C	732	87-010-196-080	CHIP CAPACITOR,0.1-25	ABCD.....
C	736	87-010-196-080	CHIP CAPACITOR,0.1-25	ABCD.....
C	731	87-010-560-080	CAP,E 10-50 GAS	ABCD.....
C	733	87-010-958-080	CHIP -CAP,S 0.01-25BJ	ABCD.....
C	734	87-012-156-080	C-CAP,S 220P-50 CH	ABCD.....
C	741	87-010-178-080	CHIP CAP 1000P	ABCD.....
D	701	87-017-931-080	ZENER,MTZJ5.6B	ABCD.....
IC	701	87-A20-613-040	C-IC,BU9262AFS	ABCD.....
L	701	87-005-448-080	COIL 220UH,K	ABCD.....
Q	732	87-A30-075-080	C-TR,2SA1235F	ABCD.....
Q	731	87-A30-076-080	C-TR,2SC3052F	ABCD.....
C	901	87-010-402-080	CAP, ELECT 2.2-50V	ABCD.....
C	902	87-010-402-080	CAP, ELECT 2.2-50V	ABCD.....
C	904	87-010-404-080	CAP, ELECT 4.7-50V	ABCD.....
C	903	87-010-404-080	CAP, ELECT 4.7-50V	ABCD.....
C	905	87-010-404-080	CAP, ELECT 4.7-50V	ABCD.....
C	909	87-016-460-080	C-CAP,S 0.22-16 B	ABCD.....
C	907	87-016-669-080	C-CAP,S 0.1-25 K B	ABCD.....
C	908	87-016-669-080	C-CAP,S 0.1-25 K B	ABCD.....
C	919	87-010-183-080	C-CAP,S 2700P-50 B	ABCD.....
C	915	87-010-197-080	CAP, CHIP 0.01 DM	ABCD.....
C	916	87-010-197-080	CAP, CHIP 0.01 DM	ABCD.....
C	918	87-010-198-080	CAP, CHIP 0.022	ABCD.....
C	917	87-010-198-080	CAP, CHIP 0.022	ABCD.....
C	914	87-010-956-080	CHIP-CAP,S 0.068-25B	ABCD.....
C	913	87-010-956-080	CHIP-CAP,S 0.068-25B	ABCD.....
C	912	87-012-365-080	C-CAP,S 0.027-25VBK	ABCD.....
C	911	87-012-365-080	C-CAP,S 0.027-25VBK	ABCD.....
C	910	87-016-460-080	C-CAP,S 0.22-16 B	ABCD.....
C	927	87-010-112-080	CAP, ELECT 100-16V	ABCD.....
C	924	87-010-178-080	CHIP CAP 1000P	ABCD.....
C	923	87-010-178-080	CHIP CAP 1000P	ABCD.....
C	926	87-010-182-080	C-CAP,S 2200P-50 B	ABCD.....
C	925	87-010-182-080	C-CAP,S 2200P-50 B	ABCD.....
C	920	87-010-183-080	C-CAP,S 2700P-50 B	ABCD.....
C	922	87-010-188-080	CAP,CHIP 6800P	ABCD.....
C	921	87-010-188-080	CAP,CHIP 6800P	ABCD.....
C	928	87-010-196-080	CHIP CAPACITOR,0.1-25	ABCD.....
C	929	87-010-322-080	C-CAP,S 100P-50 CH	ABCD.....
C	930	87-010-322-080	C-CAP,S 100P-50 CH	ABCD.....
C	931	87-010-322-080	C-CAP,S 100P-50 CH	ABCD.....
CN	901	87-099-568-010	CONN,11P TUC-P11P-B1	ABCD.....
IC	901	87-A20-869-040	C-IC,M62449FP	ABCD.....
PN	901	87-A60-546-010	CONN,11P H GRY TUC-P11X-C1	ABCD.....

ELECTRICAL MAIN PARTS LIST - 7/8

C	206	87-010-186-080	CAP,CHIP 4700P	ABCD.....
C	205	87-010-186-080	CAP,CHIP 4700P	ABCD.....
C	209	87-010-322-080	C-CAP,S 100P-50 CH	ABCD.....
C	208	87-010-404-080	CAP, ELECT 4.7-50V	ABCD.....
C	207	87-010-404-080	CAP, ELECT 4.7-50V	ABCD.....
C	203	87-010-544-080	CAP, ELECT 0.1-50V	ABCD.....
C	204	87-010-544-080	CAP, ELECT 0.1-50V	ABCD.....
C	211	87-010-260-080	CAP, ELECT 47-25V	ABCD.....
C	212	87-010-260-080	CAP, ELECT 47-25V	ABCD.....
C	210	87-010-322-080	C-CAP,S 100P-50 CH	ABCD.....
C	213	87-A10-516-080	C-CAP,S 100P-200 J CH	ABCD.....
C	214	87-A10-516-080	C-CAP,S 100P-200 J CH	ABCD.....
C	219	87-A10-712-080	C-CAP,S 0.22-50 Z F	...D.....
C	220	87-A10-712-080	C-CAP,S 0.22-50 Z F	...D.....
C	299	87-010-197-080	CAP,CHIP 0.01 DM	ABCD.....
C	305	87-010-184-080	CHIP CAPACITOR 3300P(K)	ABCD.....
C	306	87-010-184-080	CHIP CAPACITOR 3300P(K)	ABCD.....
C	309	87-010-322-080	C-CAP,S 100P-50 CH	ABCD.....
C	308	87-010-403-080	CAP, ELECT 3.3-50V	ABCD.....
C	307	87-010-403-080	CAP, ELECT 3.3-50V	ABCD.....
C	303	87-010-404-080	CAP, ELECT 4.7-50V	ABCD.....
C	304	87-010-404-080	CAP, ELECT 4.7-50V	ABCD.....
C	313	87-010-260-080	CAP, ELECT 47-25V	ABCD.....
C	314	87-010-260-080	CAP, ELECT 47-25V	ABCD.....
C	310	87-010-322-080	C-CAP,S 100P-50 CH	ABCD.....
C	319	87-A10-712-080	C-CAP,S 0.22-50 Z F	...D.....
C	312	87-A10-946-080	C-CAP,S 220P-100 J CH	ABCD.....
C	311	87-A10-946-080	C-CAP,S 220P-100 J CH	ABCD.....
C	321	87-010-186-080	CAP,CHIP 4700P	ABCD.....
C	322	87-010-186-080	CAP,CHIP 4700P	ABCD.....
C	320	87-A10-712-080	C-CAP,S 0.22-50 Z F	...D.....
C	502	87-012-368-080	C-CAP,S 0.1-50 F	ABCD.....
C	501	87-016-299-080	CAP,E 10-100 SME	ABCD.....
C	503	87-016-299-080	CAP,E 10-100 SME	ABCD.....
CN	101	87-A60-727-010	CONN,13P JL-R	ABCD.....
CN	102	87-A60-727-010	CONN,13P JL-R	ABCD.....
D	207	87-A40-488-080	DIODE,1SS244	ABCD.....
D	208	87-A40-488-080	DIODE,1SS244	ABCD.....
D	212	87-020-331-080	CHIP-DIODE,DAN202K	ABCD.....
D	293	87-020-465-080	DIODE,1SS133 (110MA)	ABCD.....
D	309	87-A40-488-080	DIODE,1SS244	ABCD.....
D	312	87-A40-270-080	C-DIODE,MC2838	ABCD.....
D	310	87-A40-488-080	DIODE,1SS244	ABCD.....
D	501	87-070-136-080	ZENER,MTZJ5.1B	ABCD.....
D	503	87-A40-345-080	ZENER,MTZJ10C	ABCD.....
D	502	87-A40-620-080	ZENER,MTZJ6.2A	ABCD.....
D	504	87-A40-646-010	DIODE,FMB-G16L	ABCD.....
D	507	87-A40-646-010	DIODE,FMB-G16L	ABCD.....
Q	209	87-A30-190-080	TR,CC5551	ABCD.....
Q	201	87-A30-268-040	C-TR,2SA1514K(S)	ABCD.....
Q	202	87-A30-268-040	C-TR,2SA1514K(S)	ABCD.....
Q	208	87-A30-268-040	C-TR,2SA1514K(S)	ABCD.....
Q	207	87-A30-268-040	C-TR,2SA1514K(S)	ABCD.....
Q	210	87-A30-190-080	TR,CC5551	ABCD.....
Q	308	87-A30-075-080	C-TR,2SA1235F	ABCD.....
Q	301	87-A30-075-080	C-TR,2SA1235F	ABCD.....
Q	307	87-A30-075-080	C-TR,2SA1235F	ABCD.....
Q	302	87-A30-075-080	C-TR,2SA1235F	ABCD.....
Q	306	87-A30-076-080	C-TR,2SC3052F	ABCD.....
Q	305	87-A30-076-080	C-TR,2SC3052F	ABCD.....
Q	317	87-A30-106-070	C-TR,CMBT5551	ABCD.....
Q	318	87-A30-106-070	C-TR,CMBT5551	ABCD.....
Q	311	87-A30-190-080	TR,CC5551	ABCD.....
Q	312	87-A30-190-080	TR,CC5551	ABCD.....
Q	325	87-A30-076-080	C-TR,2SC3052F	ABCD.....
Q	326	87-A30-076-080	C-TR,2SC3052F	ABCD.....
Q	323	87-A30-076-080	C-TR,2SC3052F	ABCD.....
Q	324	87-A30-076-080	C-TR,2SC3052F	ABCD.....
Q	503	87-A30-072-080	C-TR,RT1P 144C	ABCD.....
Q	506	87-A30-074-080	C-TR,RT1P 141C	ABCD.....
Q	505	87-A30-075-080	C-TR,2SA1235F	ABCD.....
Q	504	87-A30-076-080	C-TR,2SC3052F	ABCD.....
Q	502	87-A30-186-010	FET,2SK3053	ABCD.....
Q	501	87-A30-186-010	FET,2SK3053	ABCD.....
Q	507	87-A30-268-040	C-TR,2SA1514K(S)	ABCD.....
Q	601	87-A30-074-080	C-TR,RT1P 141C	ABCD.....
R	228	87-A00-262-080	RES,M/F 0.15-2W J	ABC.....
R	226	87-A00-262-080	RES,M/F 0.15-2W J	ABC.....
R	227	87-A00-262-080	RES,M/F 0.15-2W J	ABC.....
R	225	87-A00-262-080	RES,M/F 0.15-2W J	ABC.....
R	228	87-A00-418-010	RES,M/F 0.15-3W J	...D.....
R	227	87-A00-418-010	RES,M/F 0.15-3W J	...D.....
R	226	87-A00-418-010	RES,M/F 0.15-3W J	...D.....
R	225	87-A00-418-010	RES,M/F 0.15-3W J	...D.....
R	239	87-A00-262-080	RES,M/F 0.15-2W J	ABC.....
R	239	87-A00-418-010	RES,M/F 0.15-3W J	...D.....
R	242	87-A00-262-080	RES,M/F 0.15-2W J	ABC.....
R	242	87-A00-418-010	RES,M/F 0.15-3W J	...D.....
R	328	87-A00-258-080	RES,M/F 0.22-1W J	ABCD.....
R	327	87-A00-258-080	RES,M/F 0.22-1W J	ABCD.....
R	325	87-A00-258-080	RES,M/F 0.22-1W J	ABCD.....
R	326	87-A00-258-080	RES,M/F 0.22-1W J	ABCD.....

ELECTRICAL MAIN PARTS LIST - 8/8

R	339	87-A00-258-080	RES,M/F 0.22-1W J	ABCD.....
R	340	87-A00-258-080	RES,M/F 0.22-1W J	ABCD.....
TH	301	87-A91-042-080	C-THMS,100K 55001	ABCD.....
TH	302	87-A91-042-080	C-THMS,100K 55001	ABCD.....

MECHANICAL PARTS LIST - 1/2

NOTE: The characters in the suffix column indicate the part usage.

HASMXX.....D.....		
	KANRI			
REF.NO	PARTS NO.	NO.	DESCRIPTION	SUFFIX
	88-NF3-090-010		RING,FOOT	ABCD.....
	8Z-NF3-001-010		CABI,FR H	AB.D.....
	8Z-NF3-002-010		CABI,FR U	..C.....
	8Z-NF3-008-010		CABI,STEEL U
	8Z-NF3-009-010		CABI,STEEL	ABCD.....
	8Z-NF3-010-010		CABI,REAR USTNM	..C.....
	8Z-NF3-011-010		CABI,REAR HRJSTNM	A.....
	8Z-NF3-012-010		CABI,REAR LHSTNM	.B.....
	8Z-NF3-013-010		CABI,REAR HASTNM	...D.....
	8Z-NF3-014-010		CABI,REAR EZSTNM
	8Z-NF3-015-010		CABI,REAR LHJSTK1M
	8Z-NF3-024-010		CABI,BOTTOM	ABCD.....
	8Z-NF3-025-010		BOX,CASS L	ABCD.....
	8Z-NF3-026-010		BOX,CASS R	ABCD.....
	8Z-NF3-029-010		PANEL,REAR	ABCD.....
	8Z-NF3-030-010		PANEL,FR	.B.D.....
	8Z-NF3-031-010		PANEL,FR U	..C.....
	8Z-NF3-032-010		PANEL,FR H	A.....
	8Z-NF3-033-010		PANEL,FR RDS
	8Z-NF3-035-010		PANEL,FR LH 18
	8Z-NF3-038-010		PANEL,CD	ABCD.....
	8Z-NF3-039-010		PANEL,JOG	ABCD.....
	8Z-NF3-040-010		PANEL ASSY,TRAY	ABCD.....
	8Z-NF3-042-010		COVER, TRAY L	ABCD.....
	8Z-NF3-043-010		COVER, TRAY R	ABCD.....
	8Z-NF3-046-010		COVER, CD H	AB.D.....
	8Z-NF3-048-010		COVER, BOTTOM	ABCD.....
	8Z-NF3-050-010		WINDOW,DISP	ABCD.....
	8Z-NF3-051-010		WINDOW,DISP RDS
	8Z-NF3-055-010		WINDOW,CASS L	ABCD.....
	8Z-NF3-056-010		WINDOW,CASS R	ABCD.....
	8Z-NF3-060-010		KEY,GEQ	ABCD.....
	8Z-NF3-061-010		KEY,DSP	ABCD.....
	8Z-NF3-062-010		KEY,FUN	ABCD.....
	8Z-NF3-063-010		KEY ASSY,OPE	ABCD.....
	8Z-NF3-064-010		KEY,OPE	ABCD.....
	8Z-NF3-070-010		KEY,KARAOKE RDS
	8Z-NF3-071-010		KEY,KARAOKE H	A.....
	8Z-NF3-072-010		KEY,KARAOKE	.BCD.....
	8Z-NF3-073-010		KEY,BBE	ABCD.....
	8Z-NF3-074-010		KEY,JOG	ABCD.....
	8Z-NF3-075-010		KEY,TIMER	ABCD.....
	8Z-NF3-076-010		KEY,CLOCK	ABCD.....
	8Z-NF3-077-010		KEY,ENTER	ABCD.....
	8Z-NF3-078-010		KEY,CD	ABCD.....
	8Z-NF3-079-010		KEY,DIRECT	ABCD.....
	8Z-NF3-080-010		KEY,OPEN	ABCD.....
	8Z-NF3-090-010		KNOB,RTRY MAIN	ABCD.....
	8Z-NF3-091-010		KNOB,RTRY JOG	ABCD.....
	8Z-NF3-095-010		RING,MAIN	ABCD.....
	8Z-NF3-096-010		RING,JOG	ABCD.....
	8Z-NF3-100-010		REFLECTOR,PAUSE	ABCD.....
	8Z-NF3-101-010		REFLECTOR,FF	ABCD.....
	81-532-080-010		LABEL, CASS. COMPT	ABCD.....
	8Z-NF3-105-010		REFLECTOR,CASS	ABCD.....
	8Z-NF3-106-010		REFLECTOR,FUN	ABCD.....
	8Z-NF3-107-010		REFLECTOR,JOG	ABCD.....
	8Z-NF3-108-010		REFLECTOR,ECO	ABCD.....
	8Z-NF3-644-010		CONN ASSY,8P RPB	ABCD.....
	84-ZG1-245-210		CAP,OPTICAL	ABCD.....
	82-NF5-218-010		SPR-T,EJECT 1 (SIN)	ABCD.....
	82-NF5-219-010		SPR-T,EJECT 2 (SIN)	ABCD.....
	82-NF5-229-010		PLATE,LOCK	ABCD.....
	86-NF9-224-010		SPR-C,LOCK	ABCD.....
	87-064-185-010		HLDR,WIRE	ABCD.....
	87-NF4-216-010		HLDR,LOCK 1	ABCD.....
	87-NF4-217-010		HLDR,LOCK 2	ABC.....
	87-NF4-217-110		HLDR,LOCK 2	...D.....
	87-NF4-221-010		HLDR,CABLE	ABCD.....
	87-NF8-220-010		DMPR,150	ABCD.....
	88-NF5-208-010		HLDR,PWB-M N	ABCD.....
	8Z-NF3-224-010		HLDR,HT-SINK 1	ABCD.....
	8Z-NF3-225-010		HLDR,FAN	.BC.....
	8Z-NF3-227-010		HLDR,PWB PT	ABCD.....
	8Z-NF3-228-010		HLDR,HT-SINK R	ABCD.....
	8Z-NF3-229-010		HLDR,FAN 4CH	A..D.....
*	8Z-NF3-213-010		GUIDE,LED DIRECT	ABCD.....
	87-067-579-010		TAPPING SCREW, BVT2+3-8	...D.....
	87-067-581-010		TAPPING SCREW, BVT2+3-15	...D.....
	87-067-584-010		TAPPING SCREW, BVT2+3-6	ABCD.....
	87-067-641-010		UTT2+3-8(W/O SLOT)BL	ABCD.....
	87-067-680-010		BVI T3+3-10	ABCD.....
	87-067-688-010		BVTT+3-6	ABCD.....
	87-067-698-010		BVT2+3-18(W/O,SLOT)	...D.....
	87-067-703-010		TAPPING SCREW, BVT2+3-10	ABCD.....
	87-067-873-010		BVT2+3-25 W/O SLOT	ABC.....

MECHANICAL PARTS LIST - 2/2

		87-067-975-010	S-SCREW,IT+4-8	ABCD.....
		87-591-095-410	TAPPING SCREW, QIT+3-8 (GLD)	ABCD.....
		87-721-096-410	QT2+3-10 GLD	...D.....
		87-721-097-410	QT2+3-12 GLD	ABCD.....
		87-NF4-224-010	S-SCREW,IT3B+3-8 CU	ABCD.....
		87-085-185-010	BUSHING, AC CORD (E)	AB.D.....
		87-085-189-010	BUSHING, CORD (U)	...C.....
		87-A80-105-010	AC CORD ASSY,AZ	...D.....
		87-A80-110-010	AC CORD ASSY,U SPT-2W	...C.....
		87-A90-562-010	F-BEAD,9.5-17.5-28.5 BRH	ABCD.....
		87-A91-080-010	FAN, F614R-12MC-19-400MM	ABCD.....
		88-906-481-110	FF-CABLE, 6P 1.25 480MM	ABCD.....
		88-908-181-110	FF-CABLE, 8P 1.25 180MM	ABCD.....
		88-909-381-110	FF-CABLE,9P 1.25	ABCD.....
		88-915-161-110	FF-CABLE, 15P 1.25	ABCD.....
		8Z-NF3-646-010	CABLE,FFC 15P-CD	ABCD.....
C	231	87-018-208-080	CAP 0.047-50F
C	699	87-018-131-080	CAP, CER 1000P-50V
C	992	87-010-314-080	C-CAP,S 22P-50V
D	702	87-A40-392-010	DIODE,1N5818	ABCD.....
D	701	87-A40-392-010	DIODE,1N5818	ABCD.....
F	101	87-035-458-010	FUSE,4A 250V T W/C	AB.D.....
F	101	87-035-493-010	FUSE,8A 125V	...C.....
FB	901	87-003-223-010	FERRITE BEAD BLO2RN2
PT	1	8Z-NF3-601-010	PT,U ZNF-3	...C.....
PT	1	8Z-NF3-602-010	PT,LH ZNF-3	.B.D.....
PT	1	8Z-NF3-603-010	PT,HE ZNF-3	A.....
PT	1	8Z-NF3-604-010	PT,EZ ZNF-3
Q	102	89-213-702-010	TR,2SB1370 (1.8W)	ABCD.....
Q	101	89-213-702-010	TR,2SB1370 (1.8W)	ABCD.....
Q	217	87-A30-204-010	TR,2SD2439	ABCD.....
Q	218	87-A30-204-010	TR,2SD2439	ABCD.....
Q	216	87-A30-205-010	TR,2SB1588	ABCD.....
Q	215	87-A30-205-010	TR,2SB1588	ABCD.....
Q	314	87-A30-214-010	TR,2SB1344	ABCD.....
Q	313	87-A30-214-010	TR,2SB1344	ABCD.....
Q	315	87-A30-215-010	TR,2SD2025	ABCD.....
Q	316	87-A30-215-010	TR,2SD2025	ABCD.....
Q	701	87-A30-240-080	TR,CSA1585BC	...D.....
W	101	87-A80-092-010	AC CORD ASSY,E BLK SUN FAI	AB.....
		87-067-680-010	BVI T3+3-10	...D.....
		87-NB6-212-010	GUIDE,LED L IND	ABCD.....
		87-067-680-010	BVI T3+3-10	...D.....
WH	1	87-A90-510-010	HLDR,WIRE 2.5-9P	ABCD.....

ACCESSORIES / PACKAGE LIST - 1/1

NOTE: The characters in the suffix column indicate the part usage.

HASM	XX.....	D.....
REF.NO	PARTS NO.	KANRI NO.
		DESCRIPTION
		SUFFIX
	8Z-NF3-901-010	IB,U (ESF)M
	8Z-NF3-902-010	IB,H (ECA)M
	8Z-NF3-903-010	IB,LH (ESP)M
	8Z-NF3-904-010	IB,EZ (9L)M
	8Z-NF3-905-010	IB,HA (S)KIT
	8Z-NF3-906-010	IB,LH (P)KIT
	87-006-225-010	AM LOOP ANT NC2
	87-006-269-010	AM LOOP ANT (UN)
	87-043-095-010	WIRE ANTENNA
	87-043-106-010	WIRE, FM ANT (Z)
	87-043-115-010	ANT,FEEDER FM
	87-099-789-010	PLUG,ADPTR IR44
	8Z-NF5-702-010	RC UNIT,RC-ZAS04
		..C.....
		A.....
		.B.D.....
	
	
	
		.BCD.....
		A.....
		A.....
	
		ABCD.....
		AB.....
		ABCD.....

SCHEMATIC DIAGRAM – 1 (MAIN 1/3)

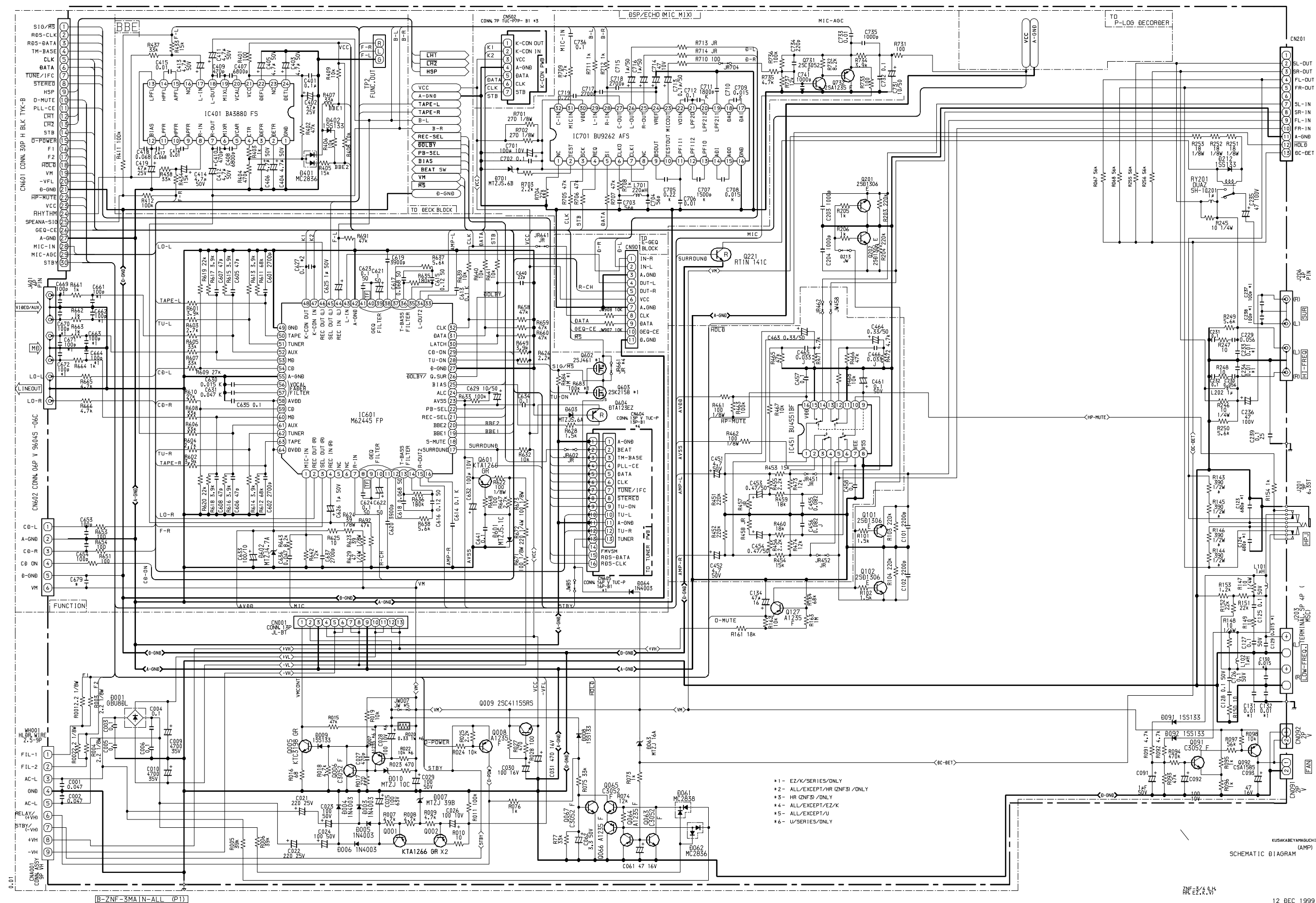

ZNF=3/4,5,6

12 DEC 1999

SCHEMATIC DIAGRAM – 2 (MAIN 2/3)

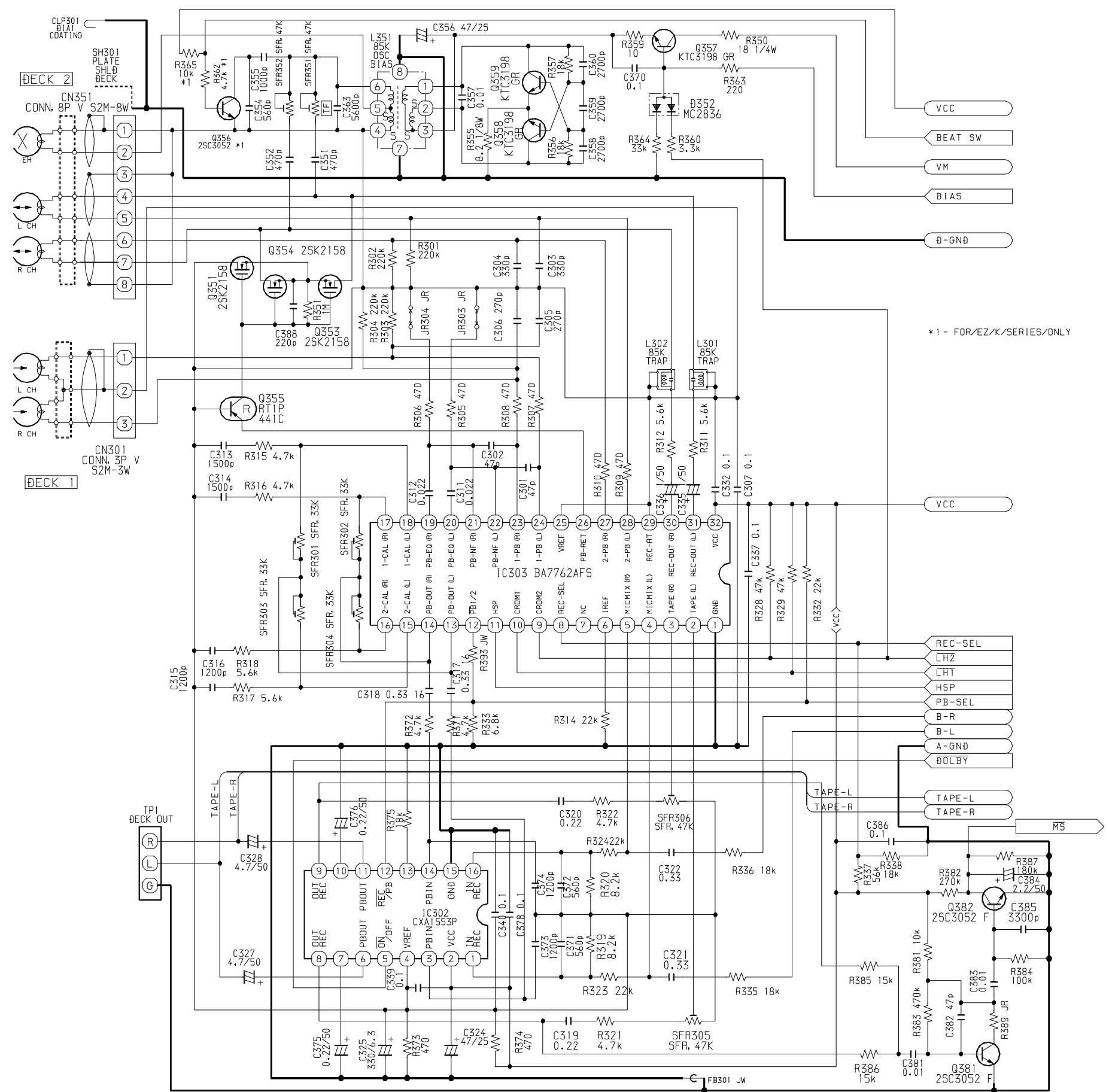

	WITH DOLBY	W/O_DOLBY (R+R)	W/O_DOLBY (R+1_1+1)
JR303	C-JR	X	X
JR304	C-JR	X	X
C379	X	22/25	22/50
C380	X	22/50	22/50
C313	1200P	1000P	1500P
C314	1200P	1000P	1500P
R315	4.7K	5.6K	5.6K
R316	4.7K	5.6K	5.6K
C315	1000P	1000P	2200P
C316	1000P	1000P	2200P
R317	5.6K	5.6K	5.6K
R318	5.6K	5.6K	5.6K
C391	270P	56P	56P
C392	270P	56P	56P
C393	270P	56P	56P
C394	270P	56P	56P
R395	X	100K	100K
R396	X	100K	100K
R397	X	100K	100K
R398	X	100K	100K
SFR301	33K	X	X
SFR302	33K	X	X
SFR303	33K	X	X
SFR304	33K	X	X
C317	0.33 BK	C-JR	C-JR
C318	0.33 BK	C-JR	C-JR
R371	4.7K	39	39
R372	4.7K	39	39
C375	0.22/50	X	X
C376	0.22/50	X	X
R375	18K	X	X
JR301	X	C-JR	C-JR
JR302	X	C-JR	C-JR

	WITH DOLBY	W/O_DOLBY (R+R_R+1_1+1)
IC302	CXA1553P	X
C309	X	0.1
C310	X	0.1
C319	0.22	X
C320	0.22	X
R321	4.7K	X
R322	4.7K	X
SFR305	50K	X
SFR306	50K	X
C371	820P	X
C372	820P	X
C373	1200P	0.15
C374	1200P	0.15
R319	4.7K	18K
R320	4.7K	18K
R323	22K	C-JR
R324	22K	C-JR
C321	0.22	0.33
C322	0.22	0.33
R335	27K	22K
R336	27K	22K
R391	X	15K
R392	X	15K
R385	15K	X
R386	15K	X
R383	470K	820K
C387	X	270P
C382	47P	15P
R389	C-JR	6.8K
Q383	X	2SA1235
C385	3300P	X

	USE BA7762AFS	USE HA12211
Q360	X	25K2158
R330	X	C-JR
R331	X	33K
JR336	X	C-JR

	EZ K MODEL	EXCEPT EZ K
Q356	2SC3052F	X
R362	4.7K	X
R365	10K	X

	EZ K MODEL	EXCEPT EZ
FB301	EM1BLO1RN1	JW

K. KOMATSU

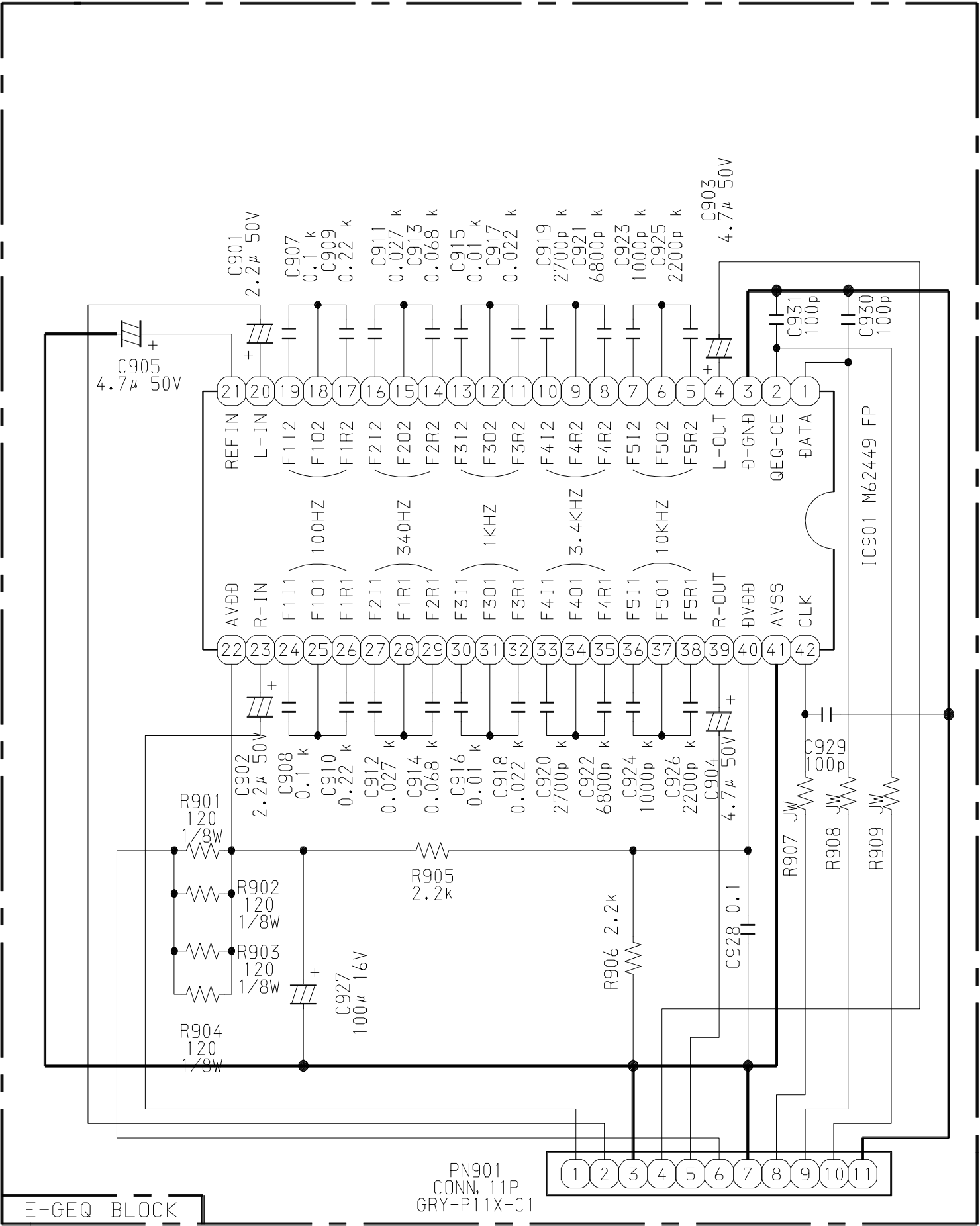

SCHEMATIC DIAGRAM – 4 (FRONT)

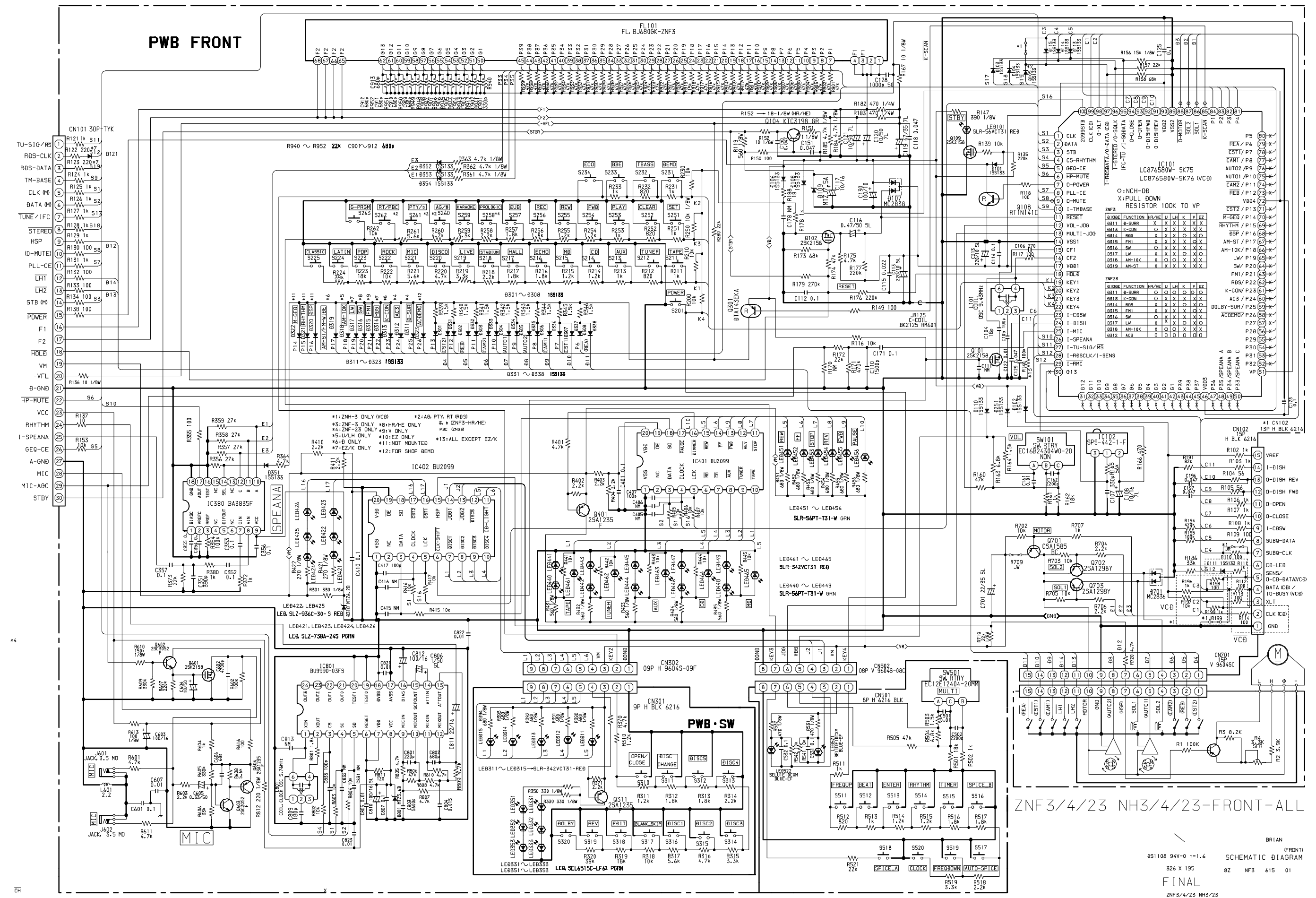

SCHEMATIC DIAGRAM – 5 (PRO)

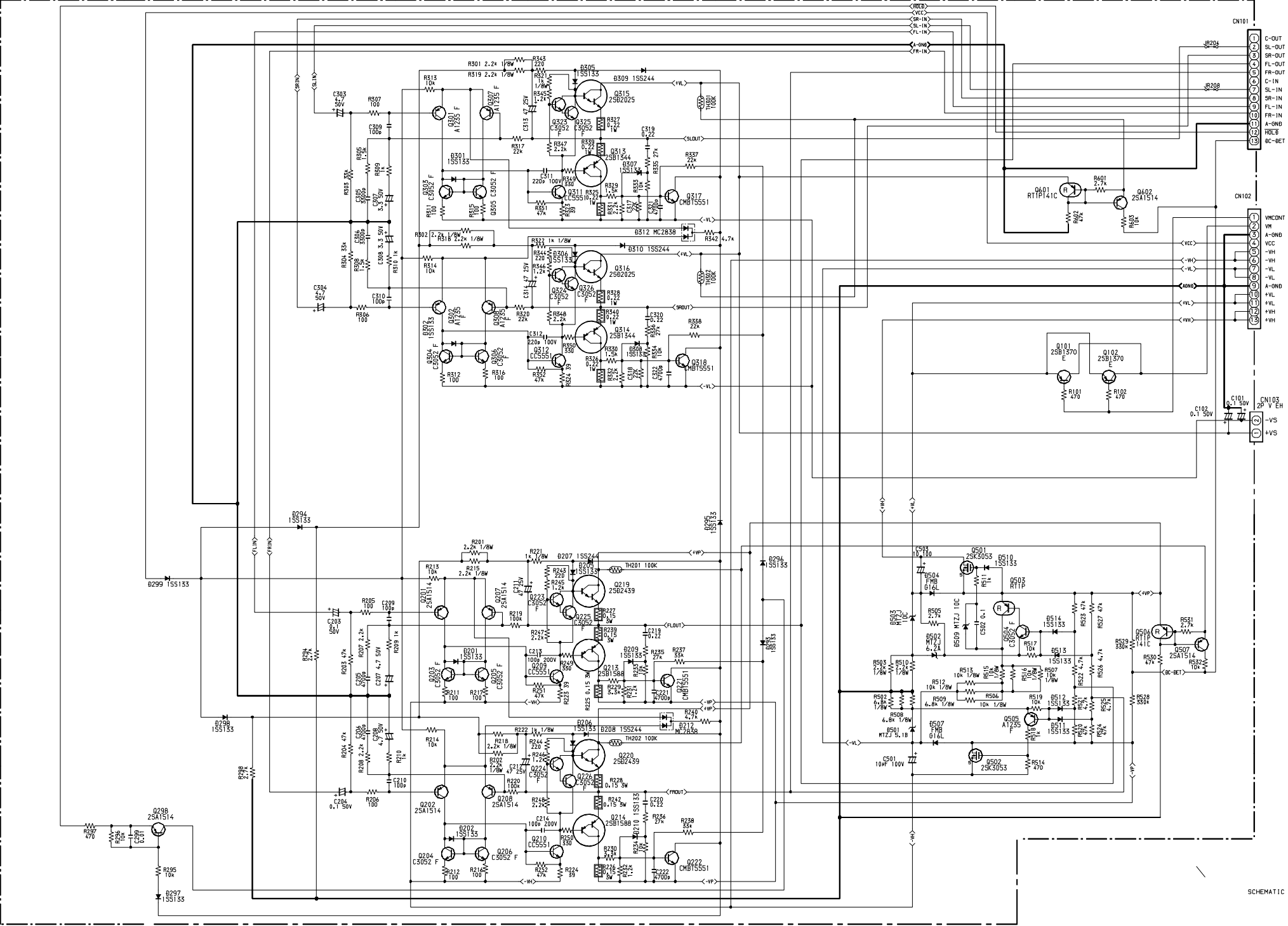

SCHEMATIC DIAGRAM – 6 (AC)

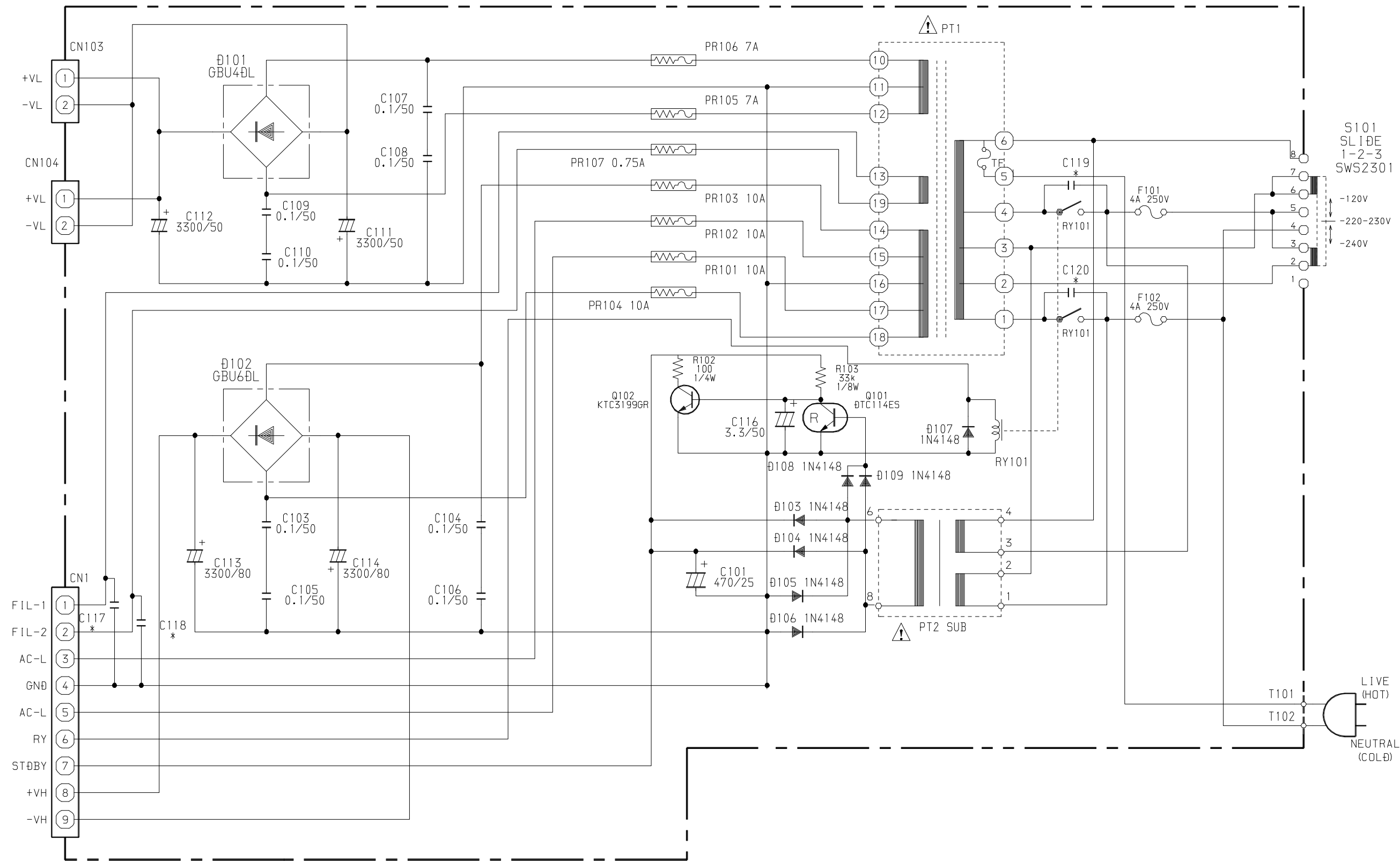

SCHEMATIC – PT

サービス技術ニュース	
番号	連絡内容
Gー	ー
Gー	ー
Gー	ー

アイワ株式会社
AIWA CO.,LTD.

9620450

Tokyo Japan